

## KD-MLV4x2Pro

4x2 4K POH/HDBaseT/HDMI/VGA Multi-View Seamless Presentation Matrix Switcher.  
(Includes 1 Rx Extender)

### Key Features

- › **Multi-View Window Processing:** Create & store custom multi-view layouts, recall custom presets in 1080p (2K) Multi-view mode
  - › **Quadrant Mode (4K or 2K):** Independent outputs in four equally-sized windows
  - › **Multi-view Mode (2K):** Linked/mirrored outputs in customized screen layout
- › **Seamless Switching:** Un-interrupted screen transitions during source selections
- › **Independent Matrix Switching:** In full-screen and quadrant modes, linked/mirrored in multi-view mode
- › **Image Layering:** Stack images with customizable priority settings
- › **Window Transparency and Border:** View content through each other and choose window bezel width and coloring
- › **Multi-format Switch:**
  - › **Input:** 2 HDMI, 2 HDMI or Analog video, all with external audio
  - › **Output:** 1 HDMI and 1 HDBaseT output. Rx unit included
- › **HDBaseT Built-In:** Included KD-X222PORx unit is powered by at KD-MLV4x2Pro
- › **Signal Extension:**
  - › Up to 200 feet @ 1080p/60, 1080p/24, 1080i, 720p with third-party CAT5e/6
  - › Up to 125 feet @ 4096x2160 30Hz [4:4:4] 8bit with third-party CAT5e/6
- › **Ultra HD/4K Up-scaling:** Outputs independently upscale to 4096x2160 30Hz [4:4:4] 8bit in 4K Quadrant mode
- › **HDCP 2.2 Licensing:** Fully licensed and compatible with HDCP 2.2
- › **Resolution Support:** Supports SD, HD, and VESA input resolutions up to 1080p / 1920x1200 on HDMI and analog video Inputs. Outputs fixed to 1080p or 4K.
- › **Audio De-Embedding:** Audio from the selected input can be de-embedded through the Coax digital (PCM) output in addition to the HDMI output
- › **Dolby Digital & DTS Audio:** Supports 2-channel and multi-channel audio formats up to 5.1 Dolby® / DTS™ lossless compressed digital surround sound
- › **Independent Video & Audio:** Listen to any audio source while in quadrant or multi-view modes

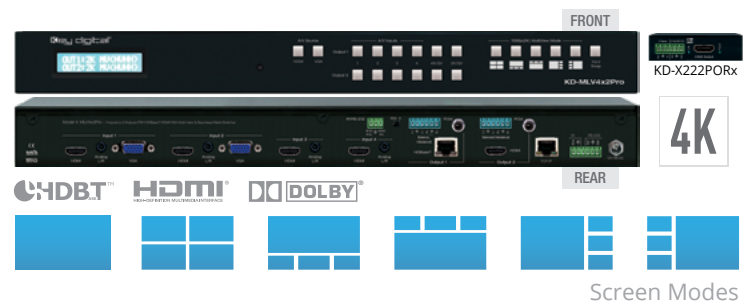

- › **Analog to Digital Video Conversion:** Analog video input ports support VGA / DB15 or Component / YpPr signal types
- › **Full Buffer System™:** Manages TMDS re-clocking / signal re-generation, HDCP authentication to source & display, and EDID Control handshake
- › **EDID:** Internal library with 5 default EDID configurations for input, in addition to native EDID data for any Output / Display
- › **TMDS Re-clocking:** Support for long HDMI connectivity using Key Digital® HDMI cables
- › **Control:** Front panel buttons, IR, RS-232, TCP/IP and Web Control
- › **Deep Color Support:** Up to 12 bits/color
- › **Web Control Interface:** Reduces installation time and provides basic and advanced video and audio setup
- › **Control System Support:** Compatible with Compass Control® Pro, AMX®, Control4®, Crestron®, KNX®, RTI®, Savant, URC®, Honeywell®, HAI®, Leviton®, etc.
- › **Key Digital® App Ready:** Can be controlled over TCP/IP via Key Digital® App

### Specifications

- › **Power Supply:** KDPS60W12VQ, 12V/5A, screw-in type
- › **Rack Mount:** 1U, full rack-width (rack ears included)
- › **Enclosure:** Black Metal
- › **Regulation:** CE, RoHS, WEEE
- › **Product:** 17.25" x 8.875" x 1.75"; Weight: 6.5 lbs
- › **Packaging:** 18.5" x 13" x 3.5"; Weight 8.8 lbs



### Digital Signage

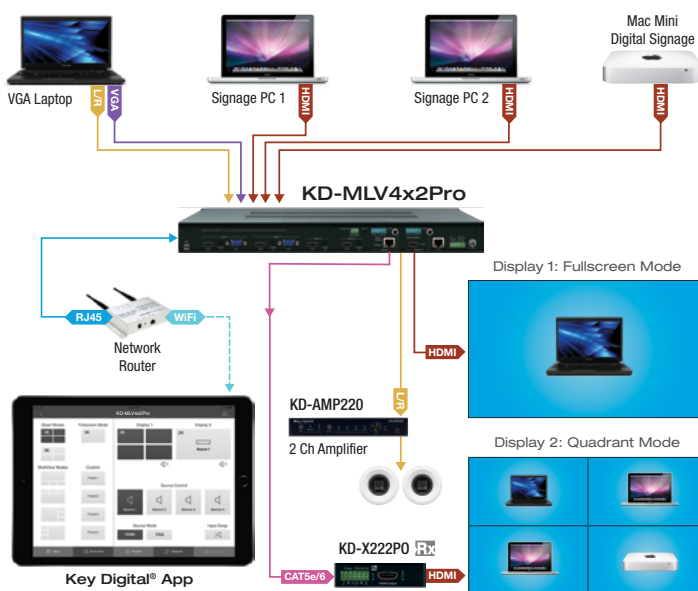

### Bar/Restaurant

